

Interior Trim and Ornamentation - Front Door Trim Panel

Removal and Installation

Removal

NOTES:



Removal steps in this procedure may contain installation details.



Some variation in the illustrations may occur, but the essential information is always correct.

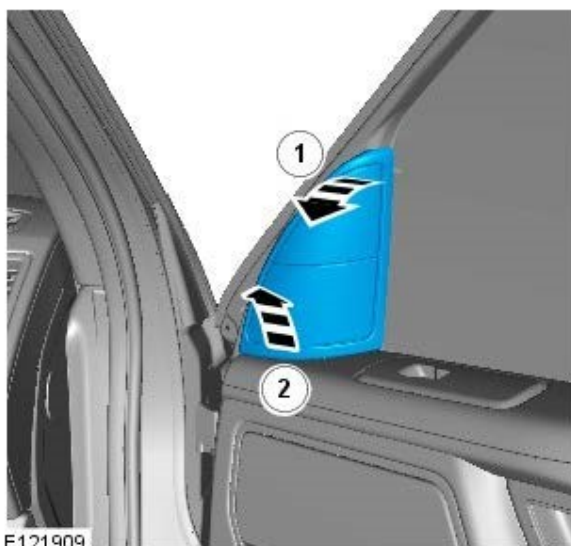

E121909

1. CAUTIONS:



Take extra care not to damage the component.



Make sure that the clips are correctly located.

Disconnect the tweeter speaker electrical connector.

2.

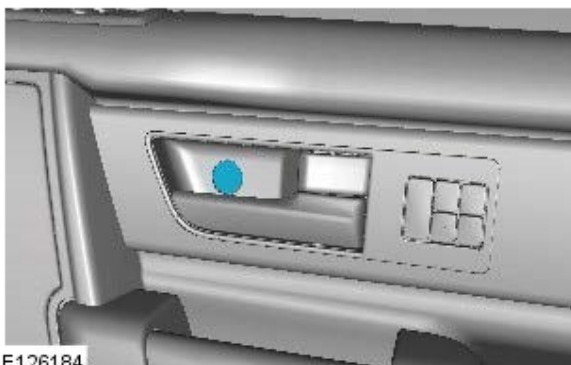

E126184

3.



E126207

4. CAUTIONS:



Take extra care not to damage the

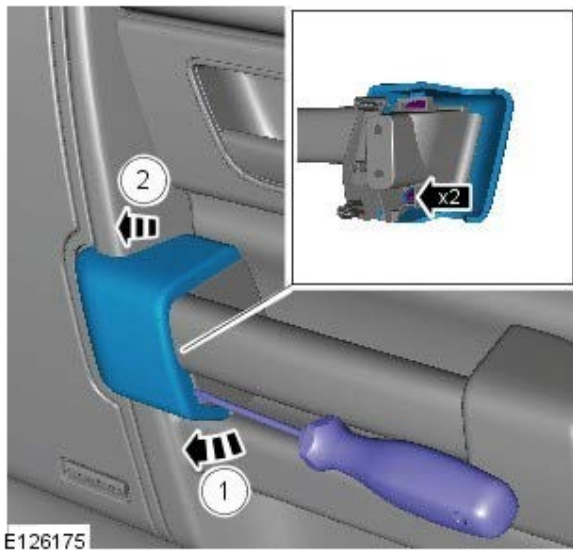

component. Apply masking tape to the end of the screwdriver.

⚠ When removing the chrome finisher from the trim panel, make sure the components are not damaged. If necessary protect the surrounding areas using masking tape.

⚠ Make sure that the clips are correctly located.

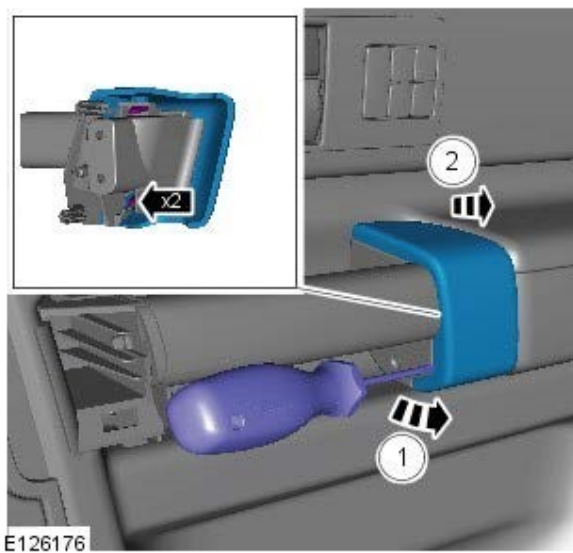

5. CAUTIONS:

⚠ Take extra care not to damage the component. Apply masking tape to the end of the screwdriver.

⚠ When removing the chrome finisher from the trim panel, make sure the components are not damaged. If necessary protect the surrounding areas using masking tape.

⚠ Make sure that the clips are correctly located.



6.

7.

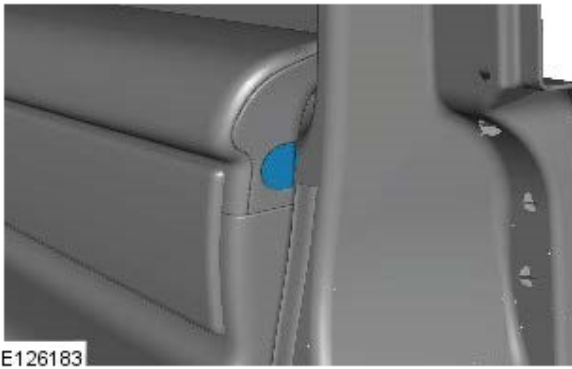

8.



9.

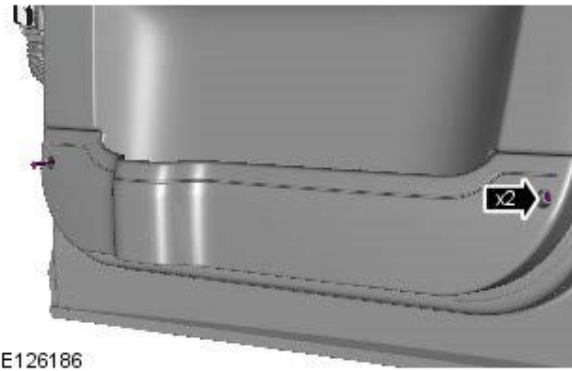

10.

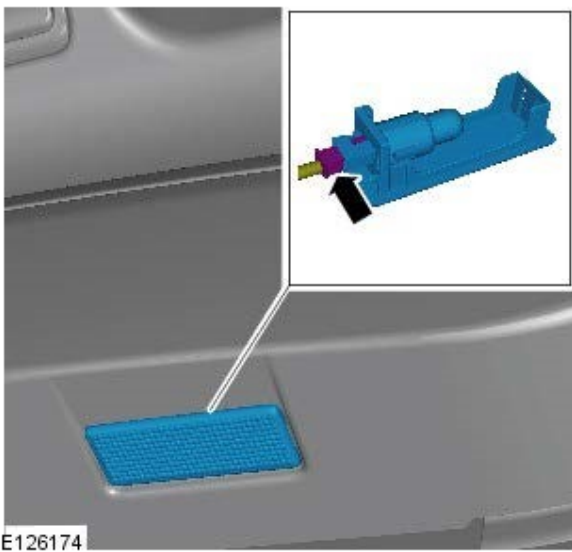

11.  **CAUTION:** Take extra care not to damage the wiring harnesses.



Detach the front door trim panel.

E126177

12.

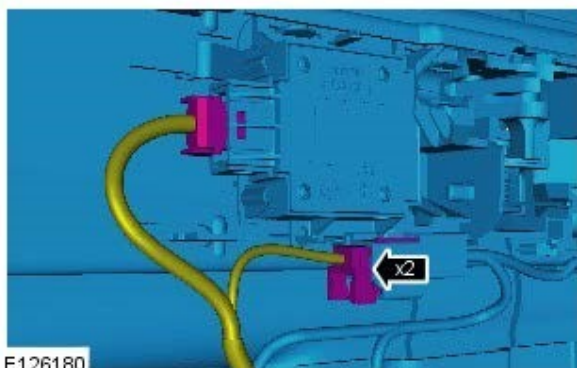

E126180

13.

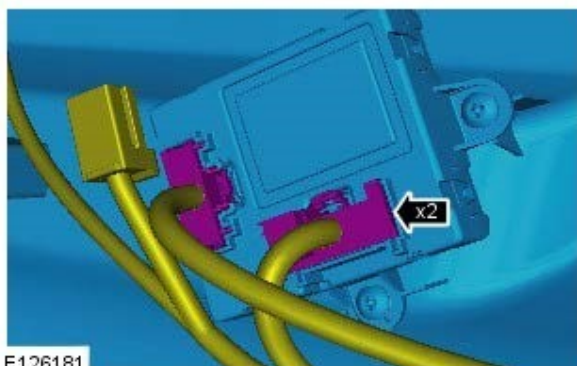

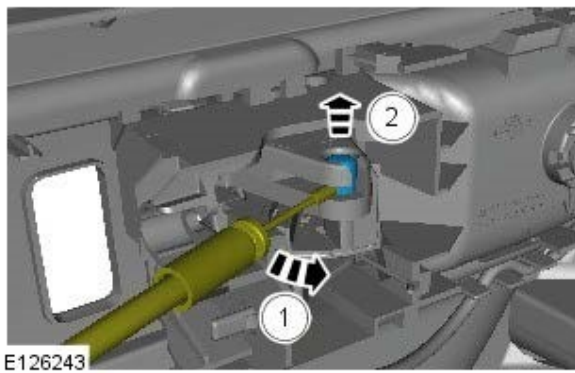
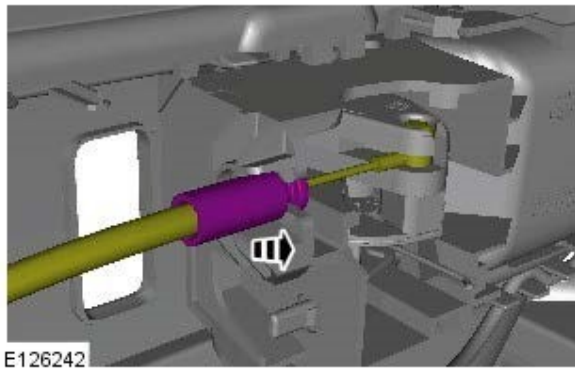
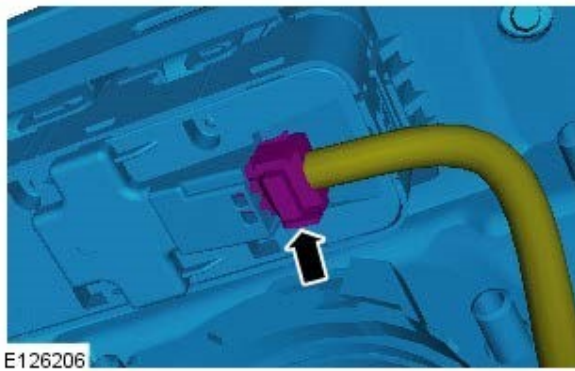

E126181

14.

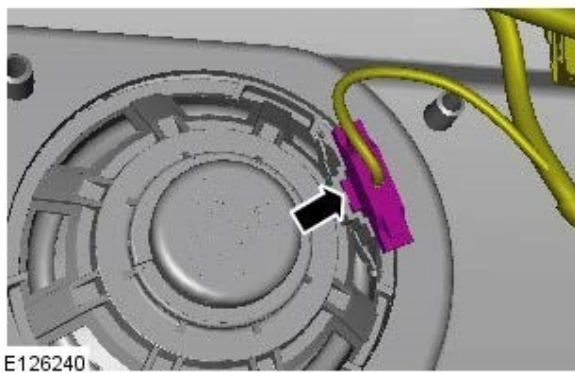

17. Remove the front door trim panel.



15.  **CAUTION:** Make sure that the release cable is removed from the door trim panel using the plastic fixing and not using the cable.

16.

18.  **NOTE:** Do not disassemble further if the component is removed for access only.

19.

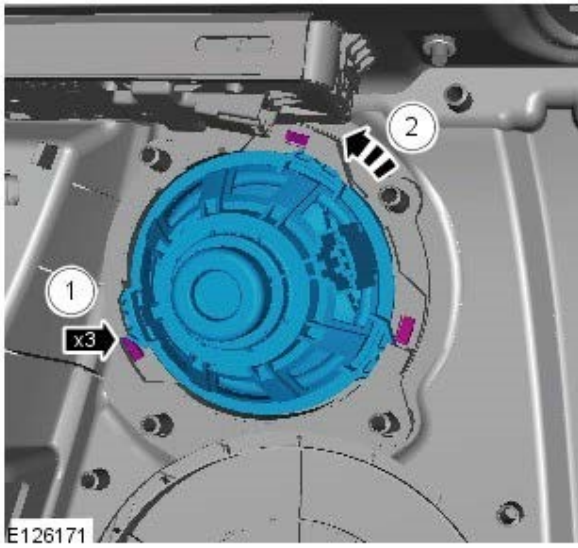

20.

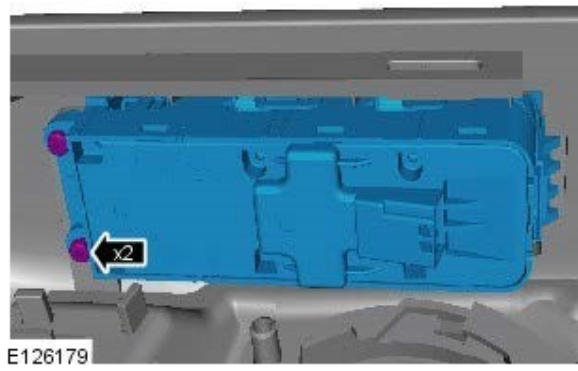

21.

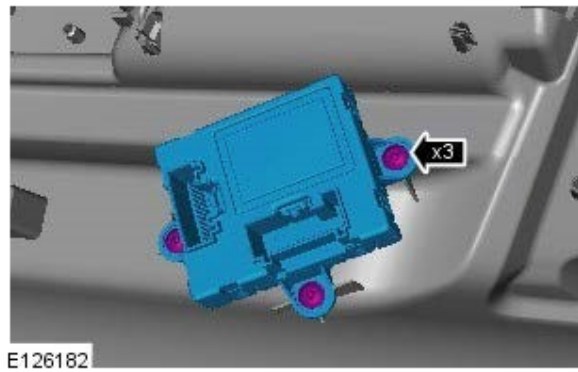

22.

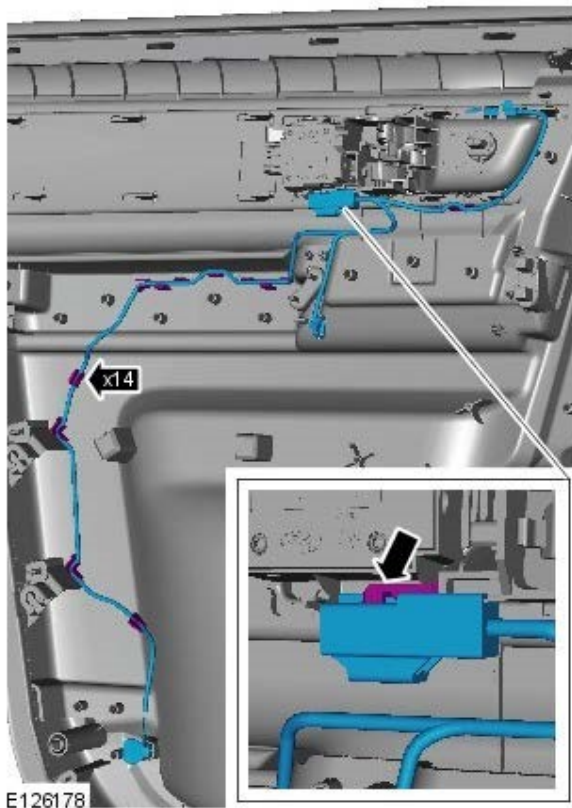

23. Release the retaining tang.

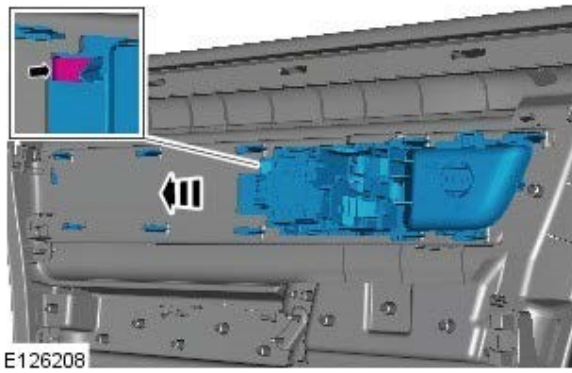

24.

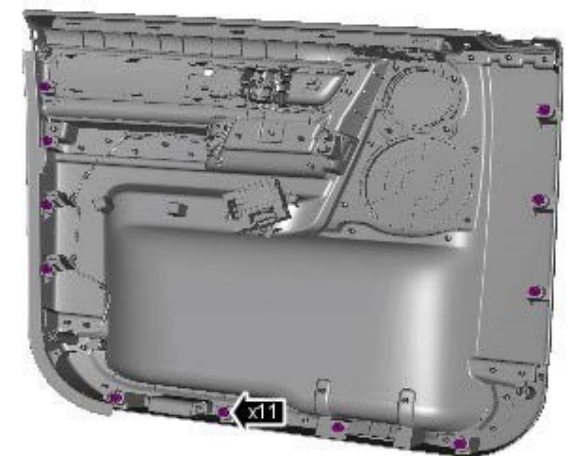

Installation

1. To install, reverse the removal procedure.